

Cable junction box "waterproof" for encapsulating



KF WP 2065

- 2.5-6 mm², Cu 3~

PC



RAL
9011

RAL
9011

10
6 Wall 5
10

- with terminals
- 5-pole per pole 4 x 2.5 mm² sol, 4 x 4 mm² sol, 3 x 6 mm² sol, 2 x 10 mm² sol
- cable entry via knockouts, order ASS separately (refer to index cable entry systems)
- cable junction box for encapsulating
- for ground installation without live loads or in risk of condensation formation and ingress of liquids
- installation permanently under water up to a depth of 1 meter possible
- with sealing compound and sealing plug
- in case of re-installation or testing the sealing compound can be removed easily
- Check the expiry date of the sealing compound!
- enclosure volume 750 ml
- colour: black, RAL 9011

Degree of protection:	For totally encapsulated cable junction boxes the degree of protection of enclosures according to DIN EN 60529 is not applicable.
rated insulation voltage	AC/DC 690 V
tightening torque for terminal	1,5 Nm
Material:	PC-GFS (polycarbonate)
width	139 mm
height:	119 mm
depth	70 mm
Weight	1.245 kg
in accordance with	DIN VDE V 0606-22-100

Drawings

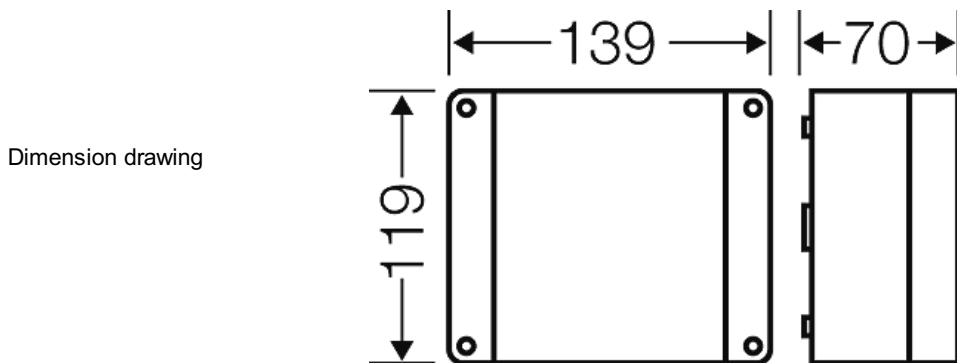

Cable junction box "waterproof" for encapsulating



KF WP 2065

- 2.5-6 mm², Cu 3~

PC



RAL
9011

RAL
9011

10

6 Wall 5

10

Detail mass

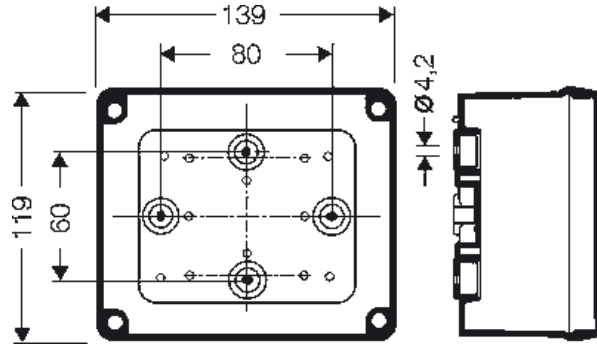

box walls

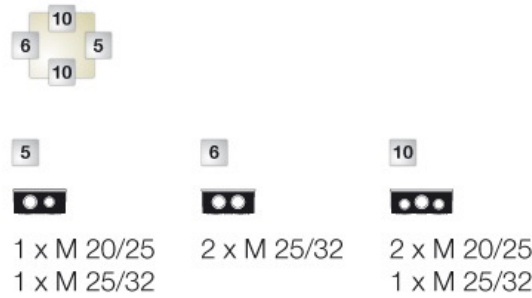

Operating and ambient conditions

Application area	Suitable for for outdoor installation (harsh environment and/or outdoor). For application in ambient conditions with formation of condensation and ingress of water as well as for installation in the ground without traffic loads in accordance with DIN VDE V 0606-22-100
Resistant to occasional cleaning procedures (direct jet)	Resistant to occasional cleaning procedures (direct jet)with high-pressure cleaner without additives, water temperature: max. 80° C
Ambient temperature	Average value over 24 hours + 55 °C Maximum value + 70 °C Minimum value - 25 °C
Relative humidity	100 %
Burning behaviour	Glow wire test IEC 60 695-2-11: 960 °C UL Subject 94: V-0 flame resistant self-extinguishing
Degree of protection against mechanical load	IK08 (5 Joule)